

**RoHS HF**

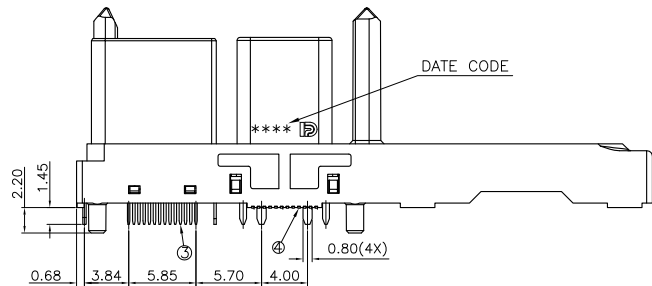
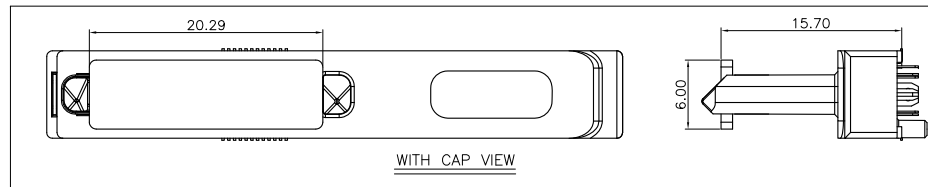
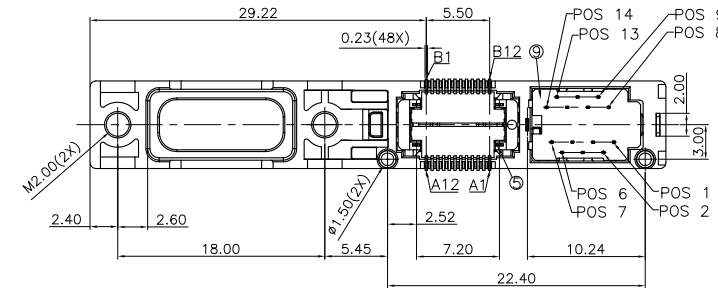
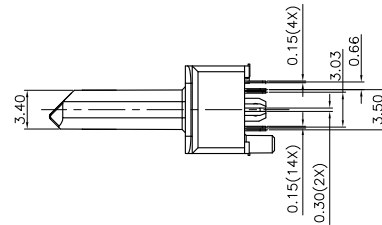
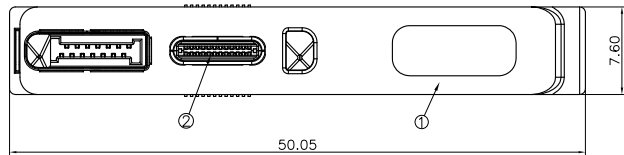
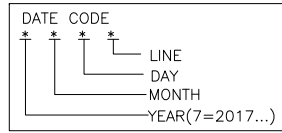
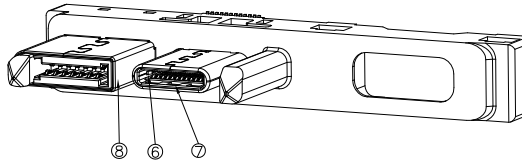
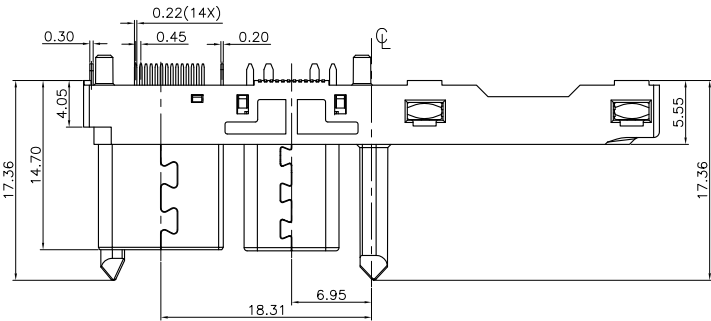

**NOTES:**

- 1.MATERIAL: SEE TABLE.
- 2.ELECTRICAL PERFORMANCES:
  - 2-1.VOLTAGE RATING: 20V DC MAX.
  - 2-2.CURRENT RATING:
    - VBUS AND GND AT RATED OF 1.25A, PARALLELED FOR A TOTAL OF 5A.
  - 2-3.LOW LEVEL CONTACT RESISTANCE:
    - TYPE C: 40mΩ MAX. FOR VBUS,GND AND OTHER CONTACTS, 50mΩ MAX. FINAL AFTER TEST PER SIGNAL CONTACTS.
  - DOCKING: SIGNAL CONTACT 120mΩ MAX. INITIAL; ΔR=30mΩ MAX. FINAL.
  - 2-4.INSULATION RESISTANCE: 500 MΩ MIN.
  - 2-5.DIELECTRIC WITHSTANDING VOLTAGE:
    - SUBJECT A VOLTAGE OF 100V AC FOR 1 MINUTE BETWEEN ADJACENT CONTACTS;
- 3.MECHANICAL PERFORMANCES:
  - 3-1.MATING FORCE:
    - 0.3~1.5Kgf FOR DK00197-D2E01-1H
    - 0.3~2.0Kgf FOR DK00197-D2E01-1H COMBINE WITH TYPEC CONDITION
  - 3-2.UNMATING FORCE:
    - 0.3~1.5Kgf FOR DK00197-D2E01-1H
    - 0.3~2.0Kgf FOR DK00197-D2E01-1H COMBINE WITH TYPEC CONDITION
  - 3-3.DURABILITY: 10000 CYCLES.
- 4.G.P PASSED ACCORD WITH RoHS STANDARD.
- 5.THE TOLERANCE FOR ALL TAIL WIDTH IS ±0.05mm AND THICKNESS IS ±0.02mm.

REV.	ECN. NO.	APPD.
A	ECN170314011	Tommy Zhang
B	ECN170905005	Tommy Zhang
C	ECN171025030	Tommy Zhang
D	ECN171127023	Tommy Zhang
E	ECN171229024	Tommy Zhang

PIN	SIGNAL	DESCRIPTION	MATING SEQUENCE	DESCRIPTION	SIGNAL	PIN
A1	GND (20V 5A)	GROUND RETURN	FIRST	GROUND RETURN	POWER GND (5A)	B12
A2	SSTXP1	POSITIVE HALF OF FIRST SUPERSPEED TX DIFFERENTIAL PAIR	SECOND	POSITIVE HALF OF FIRST SUPERSPEED RX DIFFERENTIAL PAIR	SSRXP1	B11
A3	SSTXN1	NEGATIVE HALF OF FIRST SUPERSPEED TX DIFFERENTIAL PAIR	SECOND	NEGATIVE HALF OF FIRST SUPERSPEED RX DIFFERENTIAL PAIR	SSRXN1	B10
A4	VBUS	BUS POWER	FIRST	BUS POWER	VBUS	B9
A5	CC1	CONFIGURATION CHANNEL	SECOND	SIDEBAND USE(SUB)	SBU2	B8
A6	DP1	POSITIVE HALF OF THE USB2.0 DIFFERENTIAL PAIR-POSITION 1	SECOND	NEGATIVE HALF OF THE USB2.0 DIFFERENTIAL PAIR-POSITION 2	DN2	B7
A7	DN1	NEGATIVE HALF OF THE USB2.0 DIFFERENTIAL PAIR-POSITION 1	SECOND	POSITIVE HALF OF THE USB2.0 DIFFERENTIAL PAIR-POSITION 2	DP2	B6
A8	SBU1	SIDEBAND USE(SUB)	SECOND	CONFIGURATION CHANNEL	CC2	B5
A9	VBUS	BUS POWER	FIRST	BUS POWER	VBUS	B4
A10	SSRXN2	NEGATIVE HALF OF SECOND SUPERSPEED RX DIFFERENTIAL PAIR	SECOND	NEGATIVE HALF OF SECOND SUPERSPEED TX DIFFERENTIAL PAIR	SSTXN2	B3
A11	SSRXP2	POSITIVE HALF OF SECOND SUPERSPEED RX DIFFERENTIAL PAIR	SECOND	POSITIVE HALF OF SECOND SUPERSPEED TX DIFFERENTIAL PAIR	SSTXP2	B2
A12	GND	GROUND RETURN	FIRST	GROUND RETURN	GND	B1

ITEM	DESCRIPTION	MATERIAL	FINISH	REMARK
⑨	SPACER	HIGHTEMP-PLASTIC	UL94V-0 COLOR:BLACK	
⑧	SHELL	STAINLESS STEEL	SOLDERABLE NICKEL PLATING OVER ALL.	
⑦	SPRING			
⑥	LATCH			
⑤	COVER SHELL	COPPER ALLOY	GOLD PLATING ON CONTACT AREA, NICKEL UNDERPLATING OVER ALL.	
④	SIGNAL CONTACT			
③	RJ CONTACT	HIGHTEMP-PLASTIC	UL94V-0 COLOR:BLACK	
②	INSERTMOLDING			
①	HOUSING			
UNITS: mm		GENERAL TOLERANCE		
DATE: 01/09'18		APPROVED: Tommy Zhang		PART NO.: DK00197-D2E01-1H
SCALE: 4:1		CHECKED: Mike Wu		TITLE: CUSTOMER DRAWING FOR CS18 DOCKING PLUG
SHEET: 1/3		DRAWING: Allen Wang		DRAWING NO.: 820-0000-0533
REV. E		MATERIAL: N/A		Highstar
		FINISH: N/A		Dapho ELECTRONICS TECHNOLOGY CO., LTD



**RoHS** **HF**

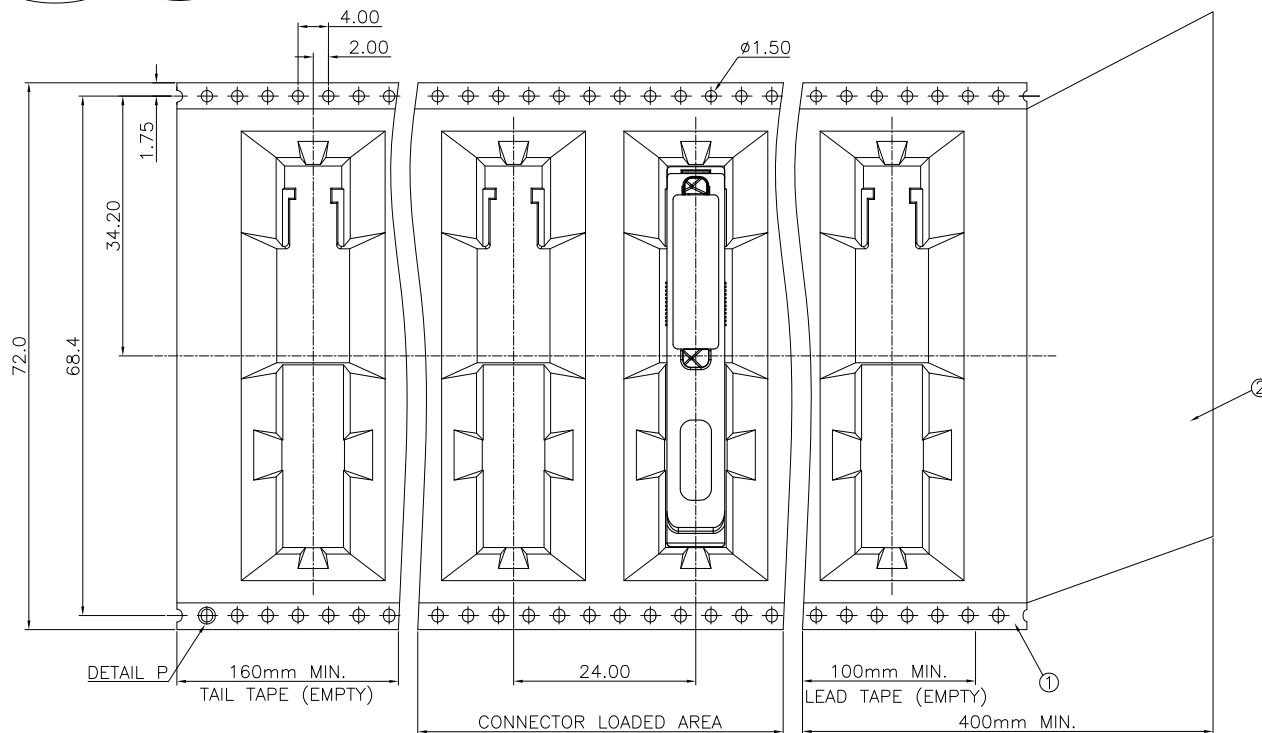

NOTES:  
 1.10 PITCHES CUMULATIVES TOLERANCE ON TAPE IS +/-0.20mm;  
 2.COVER TAPE PEELING STRENGTH :0.13Kgf MAX. AT 300mm/MINUTE;

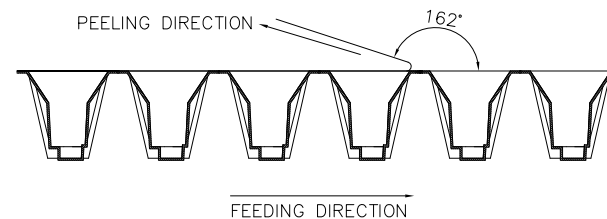

3.PACKAGING CAPACITY:

P/N	PCS/REEL	REEL/BOX	PCS/BOX
DK00197-D2E01-1H	120	4	480

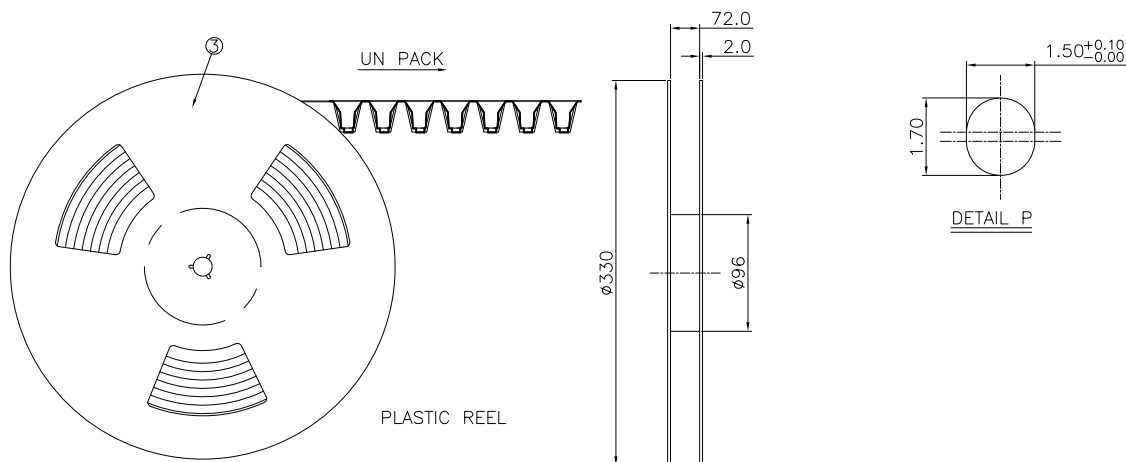

③	REEL	POLYSTYRENE
②	COVER TAPE	POLYSTER
①	CARRIER TAPE	POLYSTYRENE
ITEM	DESCRIPTION	MATERIAL

UNITS: mm	GENERAL TOLERANCE		APPROVED: Tommy Zhang	PART NO.: DK00197-D2E01-1H
DATE: 01/09'18	X. ±0.50	X.* ±3'	CHECKED: Mike Wu	TITLE:CUSTOMER DRAWING FOR CS18 DOCKING PLUG
SCALE: 1:1	.X ±0.30	.X* ±2'	DRAWING: Allen Wang	DRAWING NO.: 820-0000-0533
SHEET: 3/3	MATERIAL: N/A	Q'TY N/A	<b>Highstar</b> Drapho ELECTRONICS TECHNOLOGY CO., LTD	
REV. E	FINISH: N/A			